

MT Series(EFF2)

Three-Phase Tefc Aluminum
Induction motors



The series MT motors (center height 56-132mm,0.06-7.5kW) are totally enclosed fan cooled, three-phase, squirrel cage induction motors.

The series MT motors feature are high efficiency and starting torque, and they are also characterized by such outstanding features as: protection degree in IP55, insulation class in F (test in class B), low noise (test and load), better structure and new artistic outline.

Its cooling method is IC411. The rated output and the mounting dimensions are fully conformed to the standard IEC and DIN 42673 .

Series MT are general purpose motors suitable for driving various kinds of machines or equipment without special requirements, series MT are rated at 380V, 50Hz, Y-connection for motors up to 3kW, Δ -connection for 4kW and above. The ambient temperature is not exceeding 40°C. The altitude is not over 1000 meters above sealevel. The duty is continuous way (S1).

TECHNICAL SPECIFICATIONS



Motor Type	Rated Output Power kW	Current			Rated Speed min ⁻¹	Full-load Power factor γ cos ϕ	Full-load Eff. %	Loaked Rotor Current Is/In	Loaked Rotor Torque Ms/MN	Break Down Torque Mk/MN	Net weight kg
		380V A	400V A	415V A							
2-POLE / 3000RPM											
MT56A-2	0.09	0.39	0.37	0.36	2710	0.70	50.0	4.0	1.8	2.0	3.2
MT56B-2	0.12	0.47	0.45	0.43	2710	0.70	55.0	4.0	1.8	2.0	3.4
MT63A-2	0.18	0.58	0.55	0.53	2720	0.73	65.0	5.5	2.2	2.2	3.9
MT63B-2	0.25	0.76	0.72	0.69	2720	0.76	66.0	5.5	2.2	2.2	4.4
MT71A-2	0.37	0.99	0.94	0.91	2760	0.81	70.0	6.1	2.2	2.2	6.2
MT71B-2	0.55	1.40	1.33	1.28	2820	0.82	73.0	6.1	2.2	2.3	6.3
MT80A-2	0.75	1.83	1.74	1.68	2845	0.83	75.0	6.1	2.4	2.5	8.3
MT80B-2	1.10	2.58	2.45	2.37	2840	0.84	77.0	7.0	2.5	2.5	9.0
MT90S-2	1.50	3.43	3.26	3.14	2840	0.84	79.0	7.0	2.7	2.8	12.5
MT90L-2	2.20	4.85	4.61	4.45	2840	0.85	81.0	7.0	2.5	2.8	14.0
MT100L-2	3.00	6.31	6.00	5.78	2870	0.87	83.0	7.5	2.2	2.5	20.5
MT112M-2	4.00	8.13	7.72	7.44	2880	0.88	85.0	7.5	2.3	2.3	26.0
MT132SA-2	5.50	11.00	10.50	10.10	2901	0.88	86.0	7.5	2.3	2.5	40.0
MT132SB-2	7.50	14.90	14.10	13.60	2905	0.88	87.0	7.5	2.2	2.4	44.0
4-POLE / 1500RPM											
MT56A-4	0.06	0.28	0.27	0.26	1330	0.65	50.0	4.0	1.4	2.0	3.2
MT56B-4	0.09	0.37	0.36	0.34	1330	0.73	50.0	4.0	1.8	2.0	3.4
MT63A-4	0.12	0.44	0.42	0.41	1340	0.72	57.0	4.4	1.8	2.0	4.0
MT63B-4	0.18	0.65	0.62	0.59	1340	0.73	58.0	4.4	1.8	2.0	4.5
MT71A-4	0.25	0.79	0.75	0.72	1345	0.74	65.0	5.2	1.8	2.2	6.1
MT71B-4	0.37	1.12	1.06	1.02	1340	0.75	67.0	5.2	2.1	2.2	6.7
MT80A-4	0.55	1.57	1.49	1.44	1390	0.75	71.0	5.3	2.1	2.5	8.9
MT80B-4	0.75	2.05	1.95	1.88	1380	0.76	73.0	5.3	2.2	2.5	9.6
MT90S-4	1.10	2.85	2.71	2.61	1390	0.77	76.2	6.0	2.3	2.5	12.5
MT90L-4	1.50	3.72	3.54	3.41	1390	0.78	78.5	6.0	2.3	2.5	15.0
MT100LA-4	2.20	5.03	4.78	4.61	1415	0.82	81.0	7.0	2.3	2.5	19.2
MT100LB-4	3.00	6.73	6.39	6.16	1415	0.82	82.6	7.0	2.3	2.5	23.0
MT112M-4	4.00	8.70	8.26	7.96	1430	0.83	84.2	7.0	2.3	2.6	29.0
MT132S-4	5.50	11.70	11.20	10.80	1445	0.83	85.7	7.0	2.3	2.5	43.5
MT132M-4	7.50	15.60	14.80	14.30	1445	0.84	87.0	7.0	2.3	2.5	53.5
6-POLE / 1000RPM											
MT71A-6	0.18	0.74	0.70	0.68	860	0.66	56.0	4.0	1.9	2.0	6.4
MT71B-6	0.25	0.95	0.90	0.87	860	0.68	59.0	4.0	1.9	2.0	6.5
MT80A-6	0.37	1.30	1.23	1.19	885	0.70	62.0	4.7	2.0	2.1	8.5
MT80B-6	0.55	1.79	1.70	1.64	885	0.72	65.0	4.7	2.0	2.1	9.2
MT90S-6	0.75	2.29	2.18	2.10	915	0.72	69.0	5.5	2.0	2.2	12.0
MT90L-6	1.10	3.18	3.02	2.91	915	0.73	72.0	5.5	2.0	2.2	14.0
MT100L-6	1.50	4.00	3.80	3.66	920	0.75	76.0	5.5	2.1	2.2	19.5
MT112M-6	2.20	5.57	5.29	5.10	935	0.76	79.0	6.5	2.2	2.2	28.0
MT132S-6	3.00	7.40	7.03	6.78	960	0.76	81.0	6.5	2.2	2.8	38.0
MT132MA-6	4.00	9.75	9.26	8.93	960	0.76	82.0	6.5	2.4	2.9	45.0
MT132MB-6	5.50	12.90	12.30	11.80	960	0.77	84.0	6.5	2.4	2.8	54.0

All technical details are based on full-load 380V/50Hz

We make all efforts to better our products. Versions, technical data and figures could be changed.

They are always not binding before written confirm.

Motor Type	Rated Output Power kW	Current			Rated Speed min ⁻¹	Full-load Power factor γ cos ϕ	Full-load Eff. %	Loaked Rotor Current Is/In	Loaked Rotor Torque Ms/MN	Break Down Torque Mk/MN	Net weight kg
		380V A	400V A	415V A							
8-POLE / 750RPM											
MT80A-8	0.18	0.88	0.84	0.80	645	0.61	51.0	2.9	1.8	2.0	8.3
MT80B-8	0.25	1.15	1.10	1.06	645	0.61	54.0	2.9	1.8	2.0	9.0
MT90S-8	0.37	1.56	1.48	1.43	670	0.61	59.0	3.2	1.9	2.3	12.0
MT90L-8	0.55	2.21	2.10	2.02	670	0.61	62.0	3.2	2.0	2.3	15.0
MT100L1-8	0.75	2.43	2.31	2.22	685	0.67	70.0	4.7	1.8	2.2	19.0
MT100L2-8	1.10	3.36	3.20	3.08	690	0.69	72.0	5.0	1.8	2.2	21.8
MT112M-8	1.50	4.40	4.18	4.03	730	0.69	75.0	5.0	2.0	2.5	29.0
MT132S-8	2.20	6.04	5.73	5.53	710	0.71	78.0	6.0	1.8	2.5	39.0
MT132M-8	3.00	7.90	7.51	7.24	710	0.73	79.0	6.0	1.8	2.4	45.0

All technical details are based on full-load 380V/50Hz
 We make all efforts to better our products. Versions, technical data and figures could be changed.
 They are always not binding before written confirm.

MOUNTING ARRANGEMENTS

Types of mouning	IEC34-7 Code I	1992 Code II	Types of mouning	IEC34-7 Code I	1992 Code II
	IMB3	IM1001		IMV1	IM3011
	IMB5	IM3001		IMV5	IM1011
	IMB6			IMV6	IM1031
	IMB7			IMV15	IM2011
	IMB8			IMV15	IM12111
	IMB14	IM3601		IMV18	IM3611
	IMB34	IM2101		IMV19	IM3611
	IMB35	IM2001		IMV36	IM2031
	IMV1	IM3011			IM2131

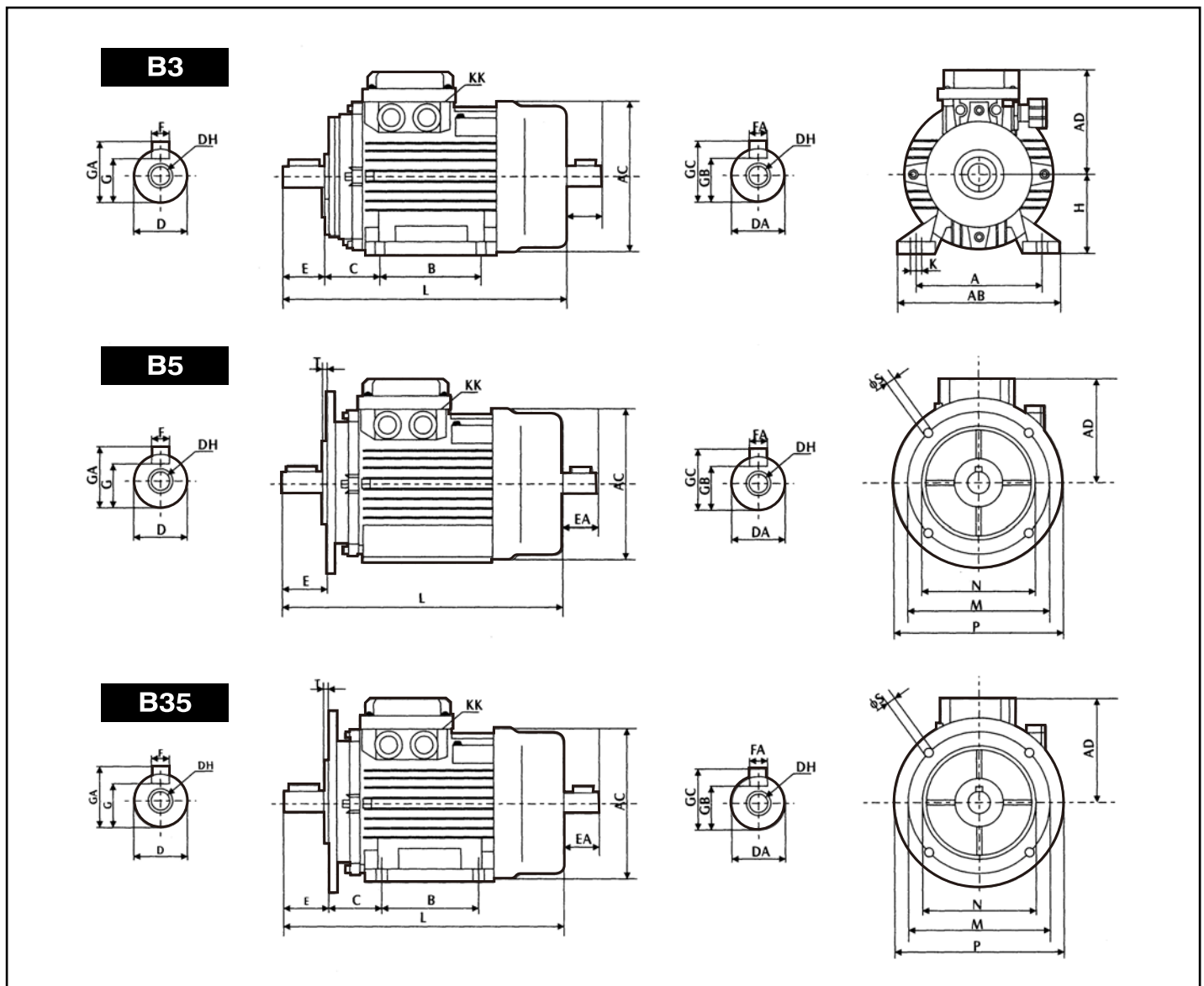

Frame size	A	AB	AC	AD	B	C	D	DH	E	F	G	H	K	KK	L	M	N	P	S	T	DA	EA	GC	GB	GA	FA
MT56	90	110	110	96	71	36	9	M4x12	20	3	7.2	56	7	2-M18x1.5	189	100	80	120	7	3	9	20	10.2	7.2	10.2	3
MT63	100	122	122	99	80	40	11	M4x12	23	4	8.5	63	7	2-M18x1.5	218	115	95	140	9	3	11	23	12.5	8.5	12.5	4
MT71	112	136	138	109	90	45	14	M5x12	30	5	11	71	7	2-M18x1.5	250	130	110	160	9	3.5	14	30	16	11	16	5
MT80	125	154	157	112	100	50	19	M6x16	40	6	15.5	80	10	2-M20x1.5	278	165	130	200	12	3.5	14	30	16	11	21.5	5
MT90S	140	174	175	120	100	56	24	M8x19	50	8	20	90	10	2-M20x1.5	335	165	130	200	12	3.5	19	40	21.5	15.5	27	6
MT90L	140	174	175	120	125	56	24	M8x19	50	8	20	90	10	2-M20x1.5	335	165	130	200	12	3.5	19	40	21.5	15.5	27	6
MT100L	160	194	196	139	140	63	28	M10x22	60	8	24	100	12	2-M20x1.5	377	215	180	250	15	4	28	60	31	24	31	8
MT112M	190	224	220	156	140	70	28	M10x22	60	8	24	112	12	2-M20x1.5	395	215	180	250	15	4	28	60	31	24	31	8
MT132S	216	256	260	185	140	89	38	M12x28	80	10	33	132	12	2-M25x1.5	472	265	230	300	15	4	38	80	41	33	41	10
MT132M	216	256	260	185	178	89	38	M12x28	80	10	33	132	12	2-M25x1.5	510	265	230	300	15	4	38	80	41	33	41	10

B14

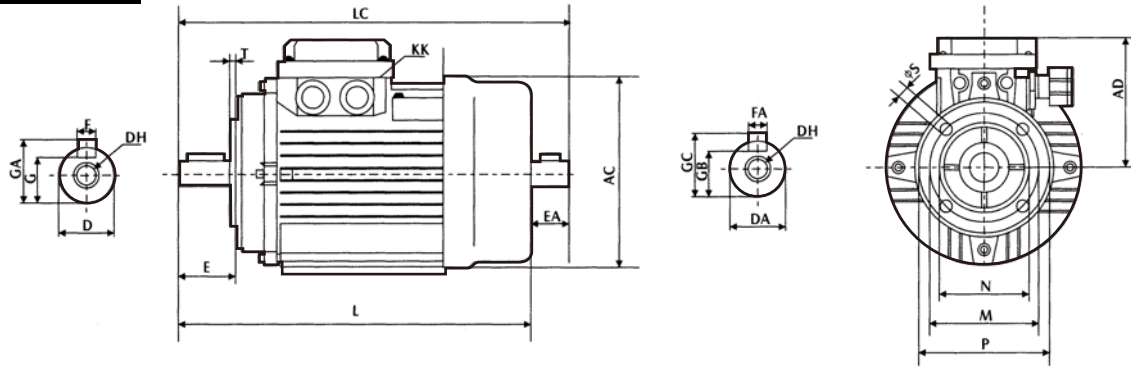

B34

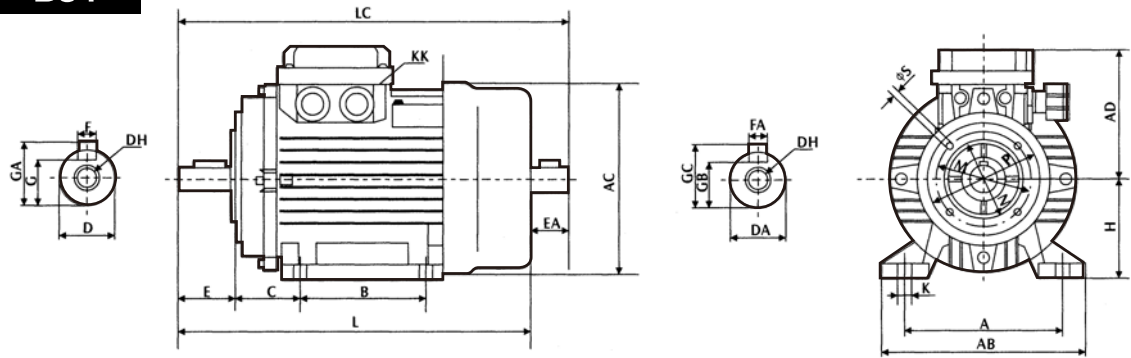

Frame size	A	AB	AC	AD	B	C	D	DH	E	F	G	H	K	KK	L	M	N	P	S	T	DA	EA	GC	GB	GA	FA
------------	---	----	----	----	---	---	---	----	---	---	---	---	---	----	---	---	---	---	---	---	----	----	----	----	----	----

MT56	90	110	110	96	71	36	9	M4x12	20	3	7.2	56	7	2-M18x1.5	189	65	50	80	M5	3	9	20	10.2	7.2	10.2	3
MT63	100	122	122	99	80	40	11	M4x12	23	4	8.5	63	7	2-M18x1.5	218	75	60	90	M5	3	11	23	12.5	8.5	12.5	4
MT71	112	136	138	109	90	45	14	M5x12	30	5	11	71	7	2-M18x1.5	250	85	70	105	M6	3.5	14	30	16	11	16	5
MT80	125	154	157	112	100	50	19	M6x16	40	6	15.5	80	10	2-M20x1.5	278	100	80	120	M6	3.5	14	30	16	11	21.5	5
MT90S	140	174	175	120	100	56	24	M8x19	50	8	20	90	10	2-M20x1.5	335	115	95	140	M8	3.5	19	40	21.5	15.5	27	6
MT90L	140	174	175	120	125	56	24	M8x19	50	8	20	90	10	2-M20x1.5	335	115	95	140	M8	3.5	19	40	21.5	15.5	27	6
MT100L	160	194	196	139	140	63	28	M10x22	60	8	24	100	12	2-M20x1.5	377	130	110	160	M8	4	28	60	31	24	31	8
MT112M	190	224	220	156	140	70	28	M10x22	60	8	24	112	12	2-M20x1.5	395	130	110	160	M8	4	28	60	31	24	31	8
MT132S	216	256	260	185	140	89	38	M12x28	80	10	33	132	12	2-M25x1.5	472	165	130	200	M10	4	38	80	41	33	41	10
MT132M	216	256	260	185	178	89	38	M12x28	80	10	33	132	12	2-M25x1.5	510	165	130	200	M10	4	38	80	41	33	41	10

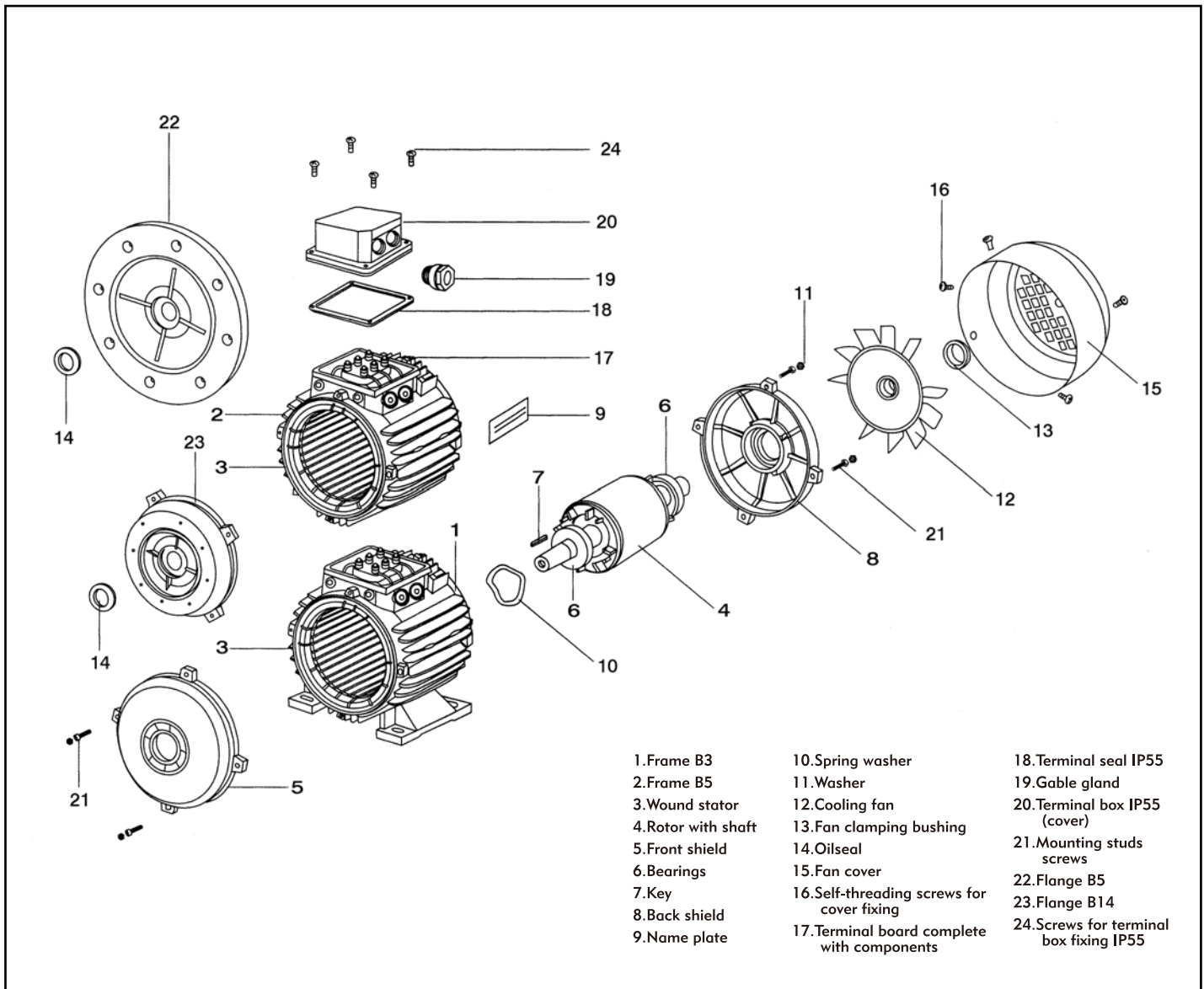

Frame Size	Driving End Bearings	Non driving End Bearings	Oil Seal	PG Thread
56	6201 2RS / C3	6201 2RS / C3	Ø12 x Ø22 x 5	PG11
63	6201 2RS / C3	6201 2RS / C3	Ø12 x Ø22 x 7	PG11
71	6202 2RS / C3	6202 2RS / C3	Ø15 x Ø25 x 7	PG11
80	6204 2RS / C3	6204 2RS / C3	Ø20 x Ø30 x 7	PG13.5
90	6205 2RS / C3	6205 2RS / C3	Ø25 x Ø37 x 7	PG16
100	6206 2RS / C3	6206 2RS / C3	Ø30 x Ø42 x 7	PG16
112	6206 2RS / C3	6206 2RS / C3	Ø30 x Ø42 x 7	PG21
132	6208 2RS / C3	6208 2RS / C3	Ø40 x Ø58 x 8	PG21

This catalogue is only a reference for users.
 The concrete date may be changed, please contact with us before ordering.